

1 Large Panel - RV Kit

Install Diagram

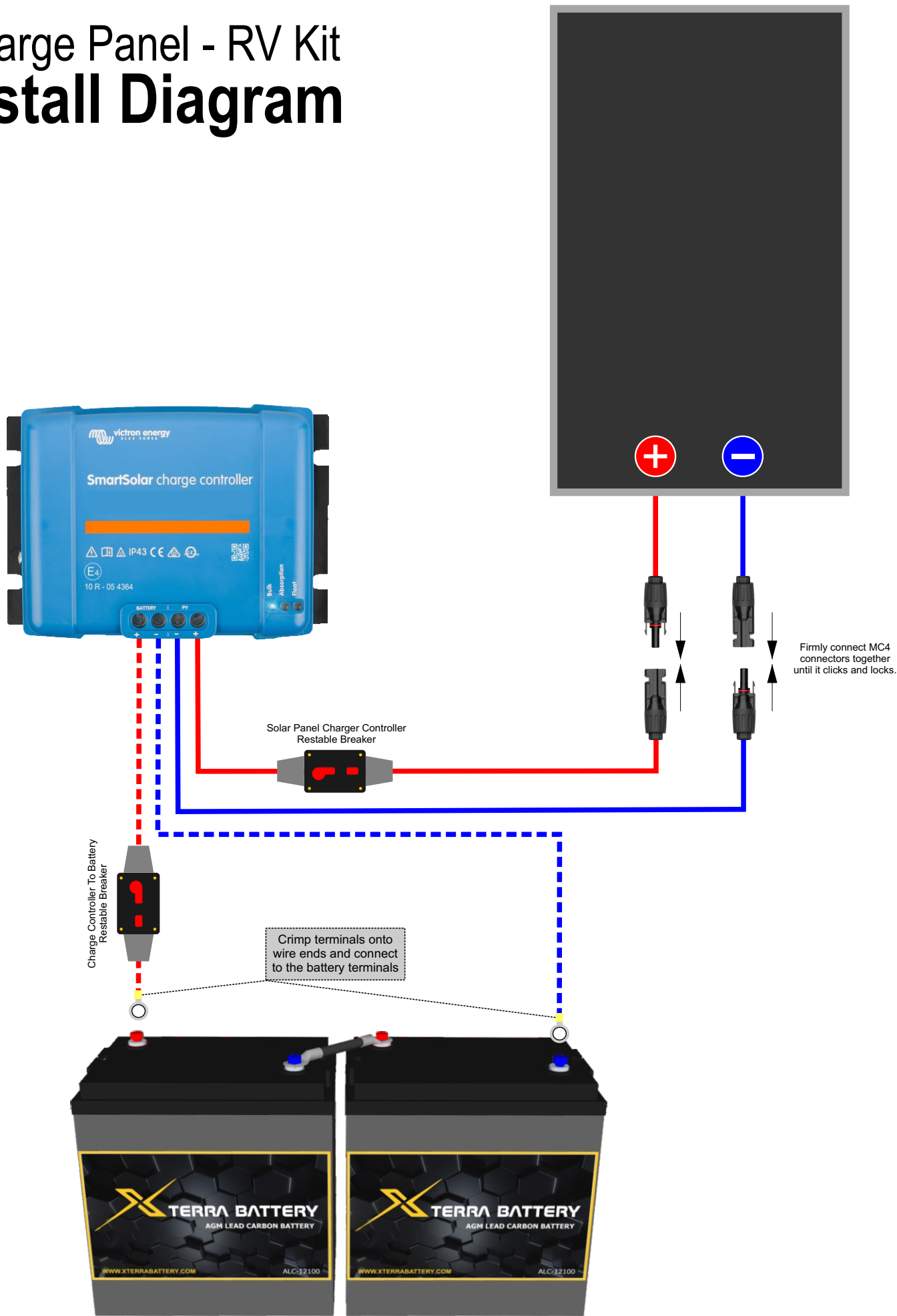

2 Large Panel - RV Kit Install Diagram

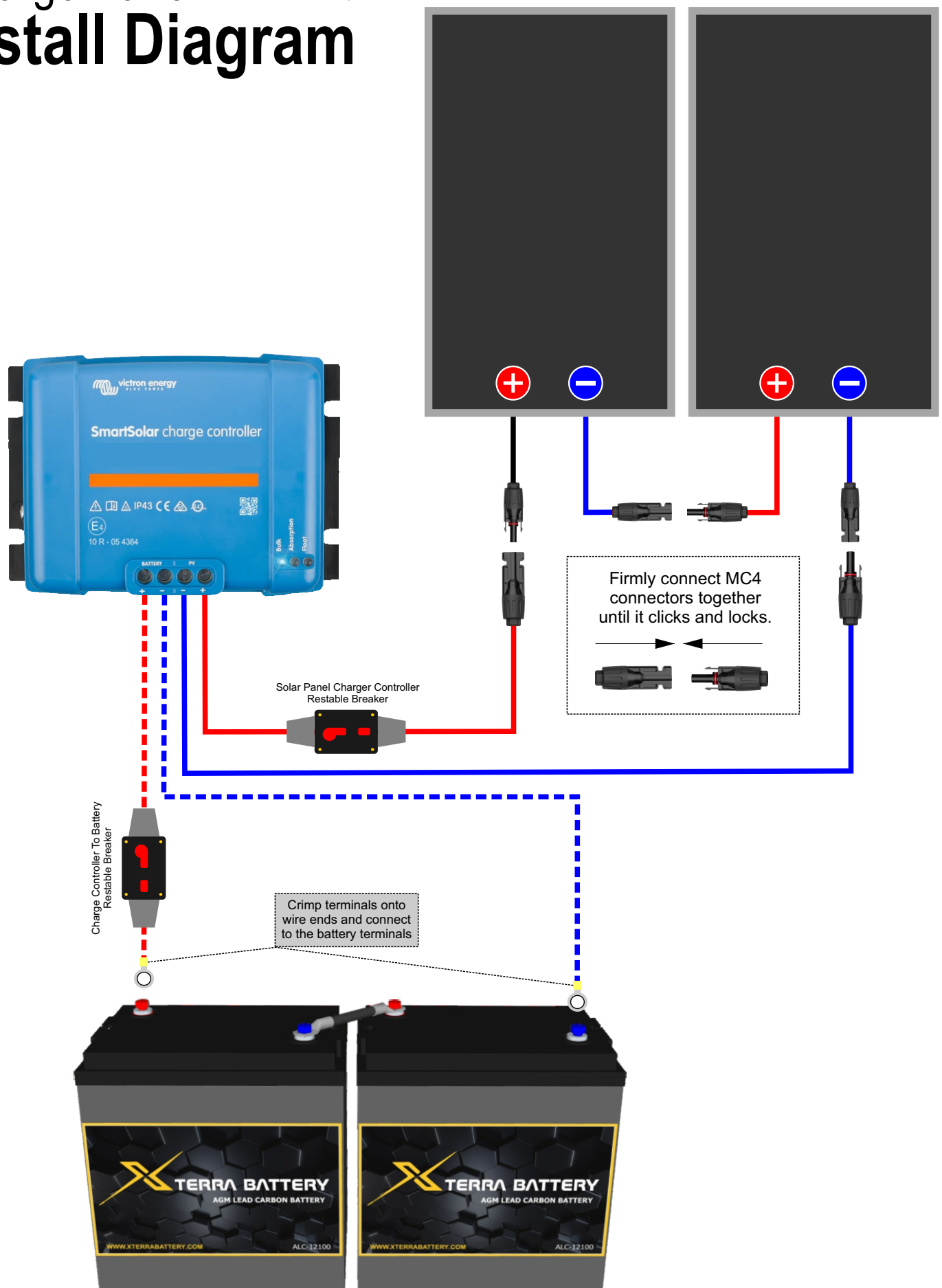

3 Large Panel - RV Kit

Install Diagram

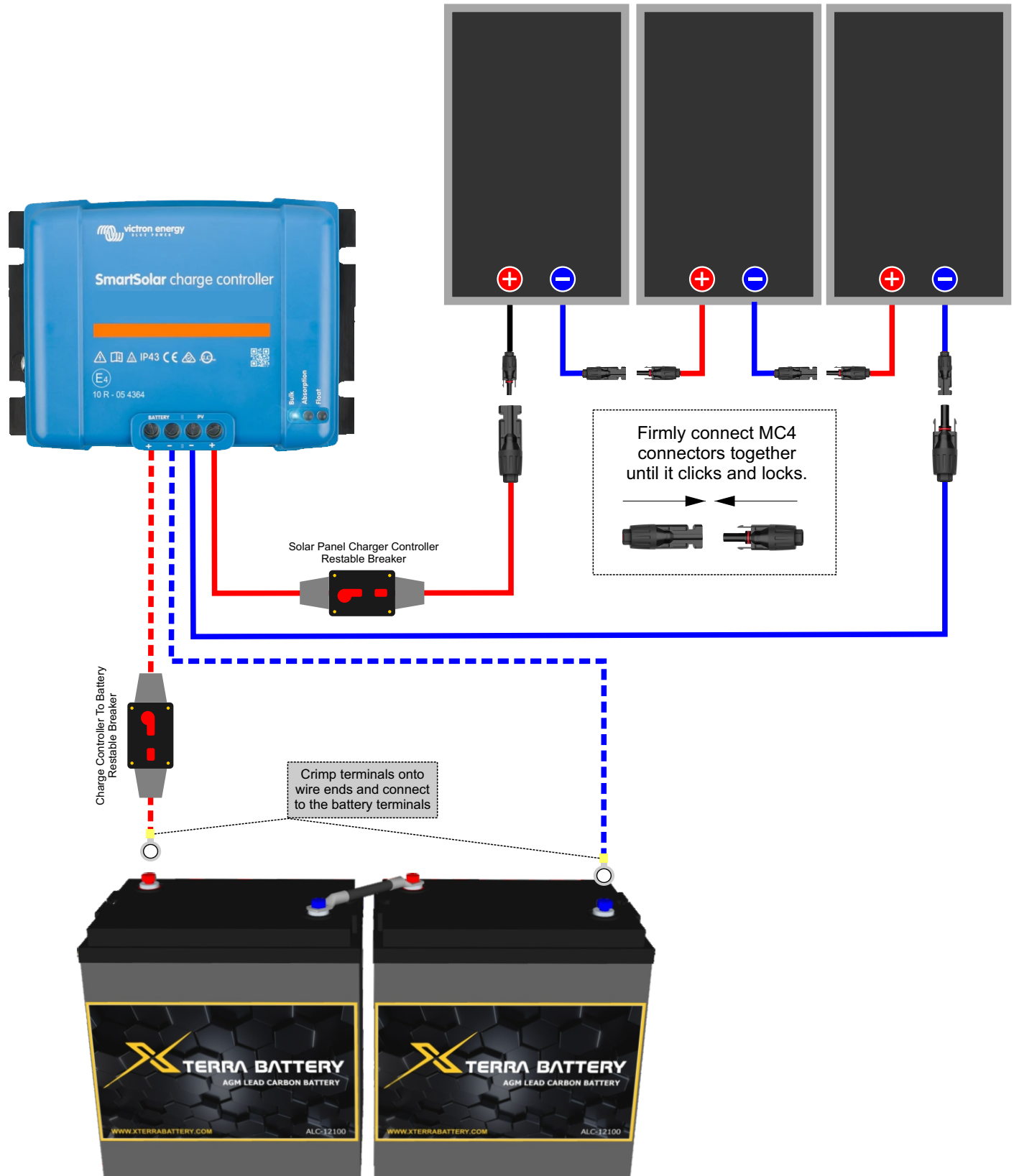

Z-BRACKET MOUNTING KIT

INSTALLATION GUIDE

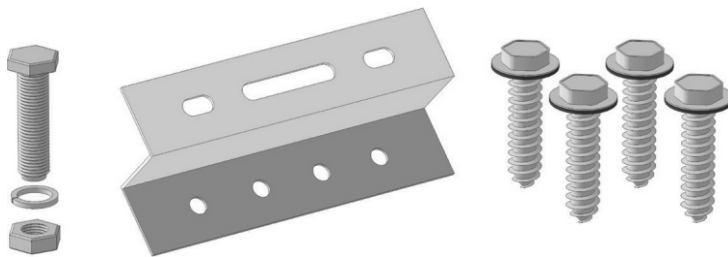

Mount four (4) Z-brackets with one bolt, lock washer, and nut to the holes in the frame of the solar panel located one foot (1') from the top and bottom of the frame. Hold the nut on the back side with a wrench and tighten bolt. Ensure the lock washer is between the frame of solar panel and the nut.

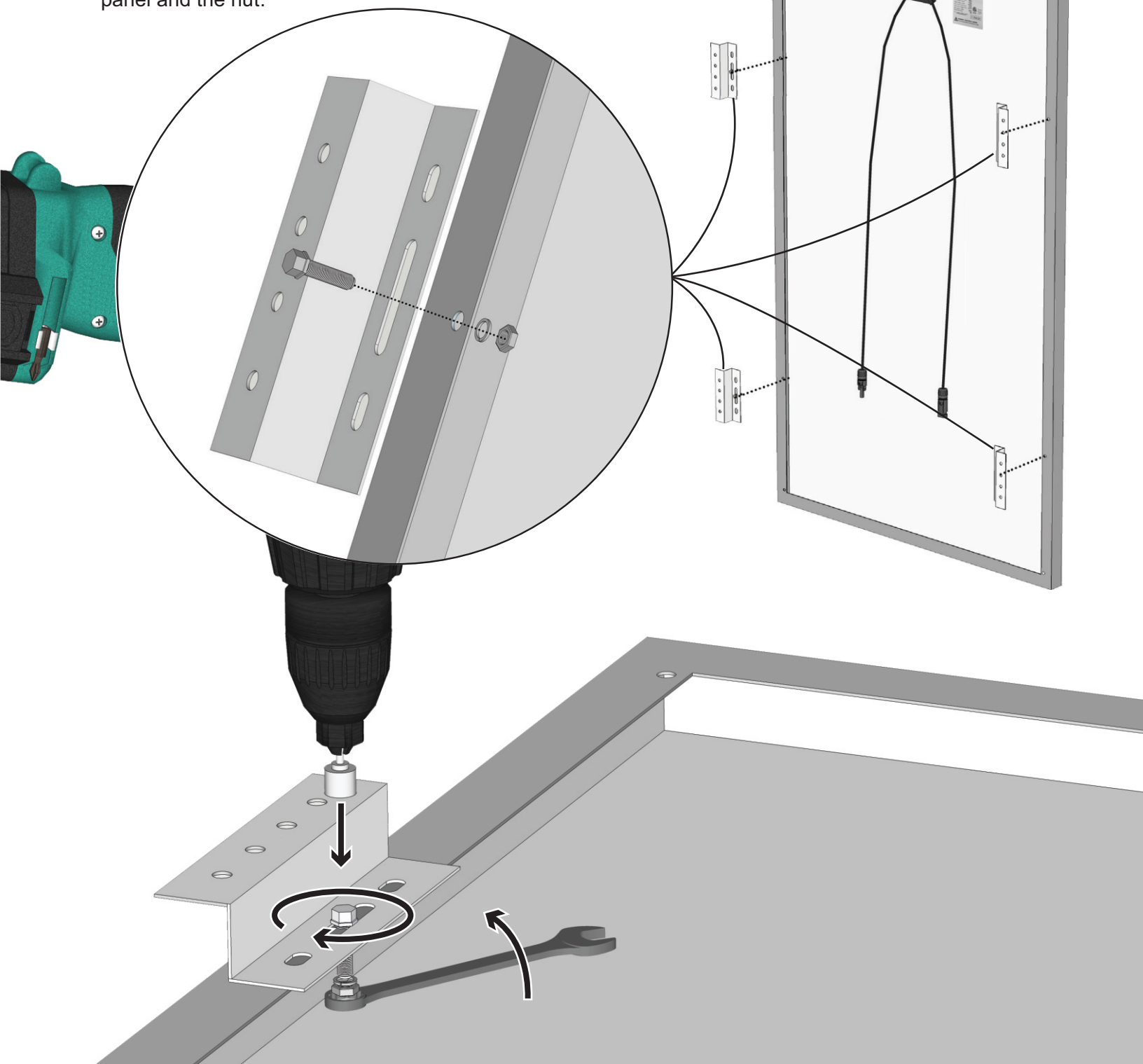

Before placing the solar panel(s) on the roof, make sure to pull the wires from underneath the panel aside as they will be very difficult to access once the panel(s) is attached to the roof. Once you have chosen where the panel(s) will be mounted, place them on the roof and drill four (4) pilot holes for each bracket. **DO NOT USE EXCESSIVE FORCE.** Your pilot holes does not need to be more than 1" deep.

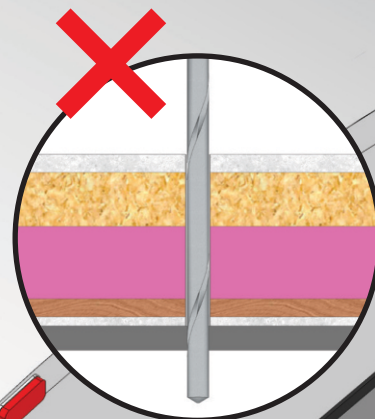
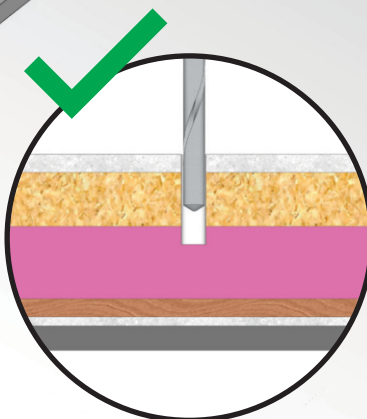
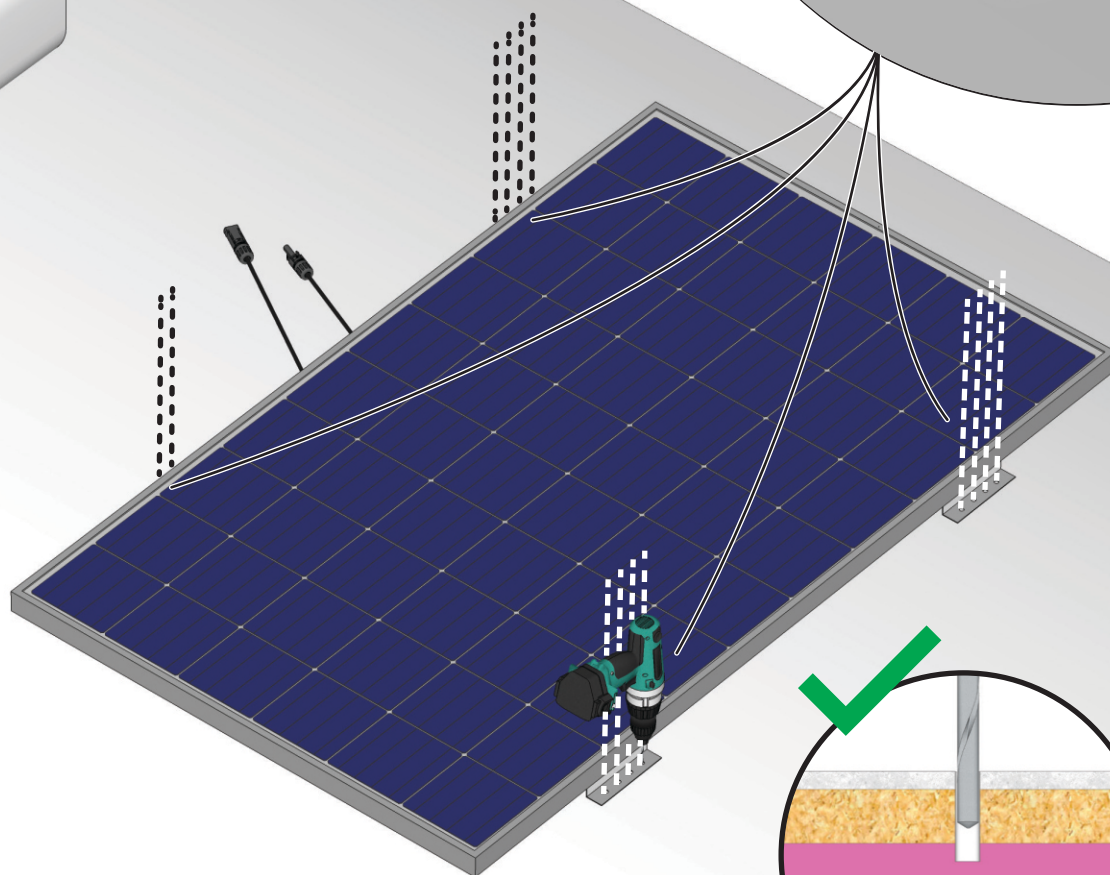
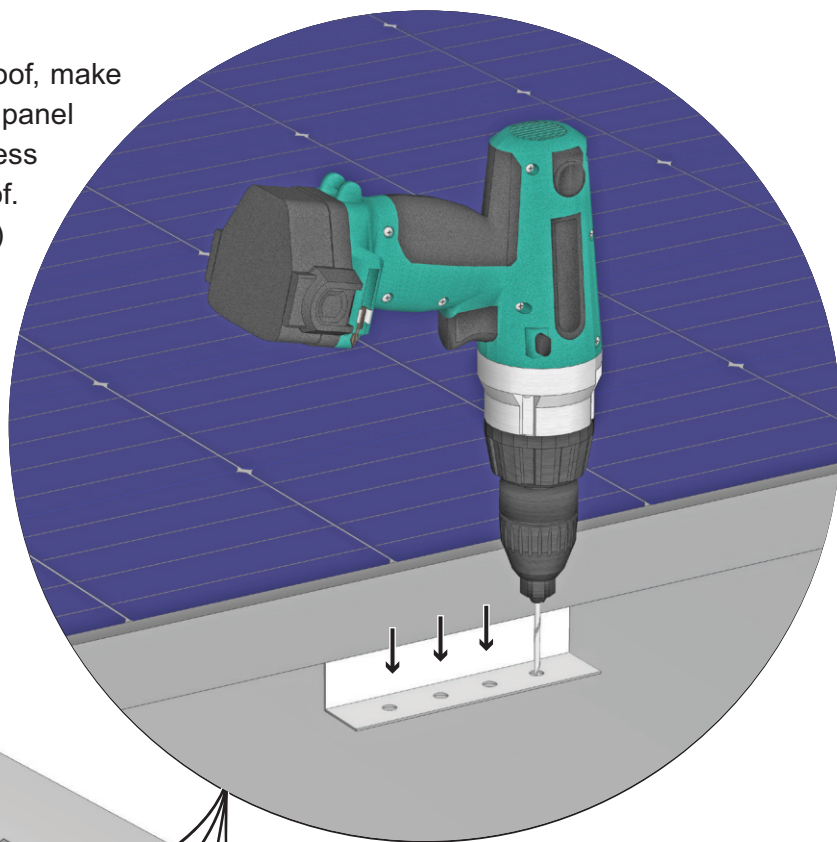

Flip the panel over and apply the caulking liberally to the bottom of each Z-bracket. Now apply a dab of caulking to each of the pilot holes.

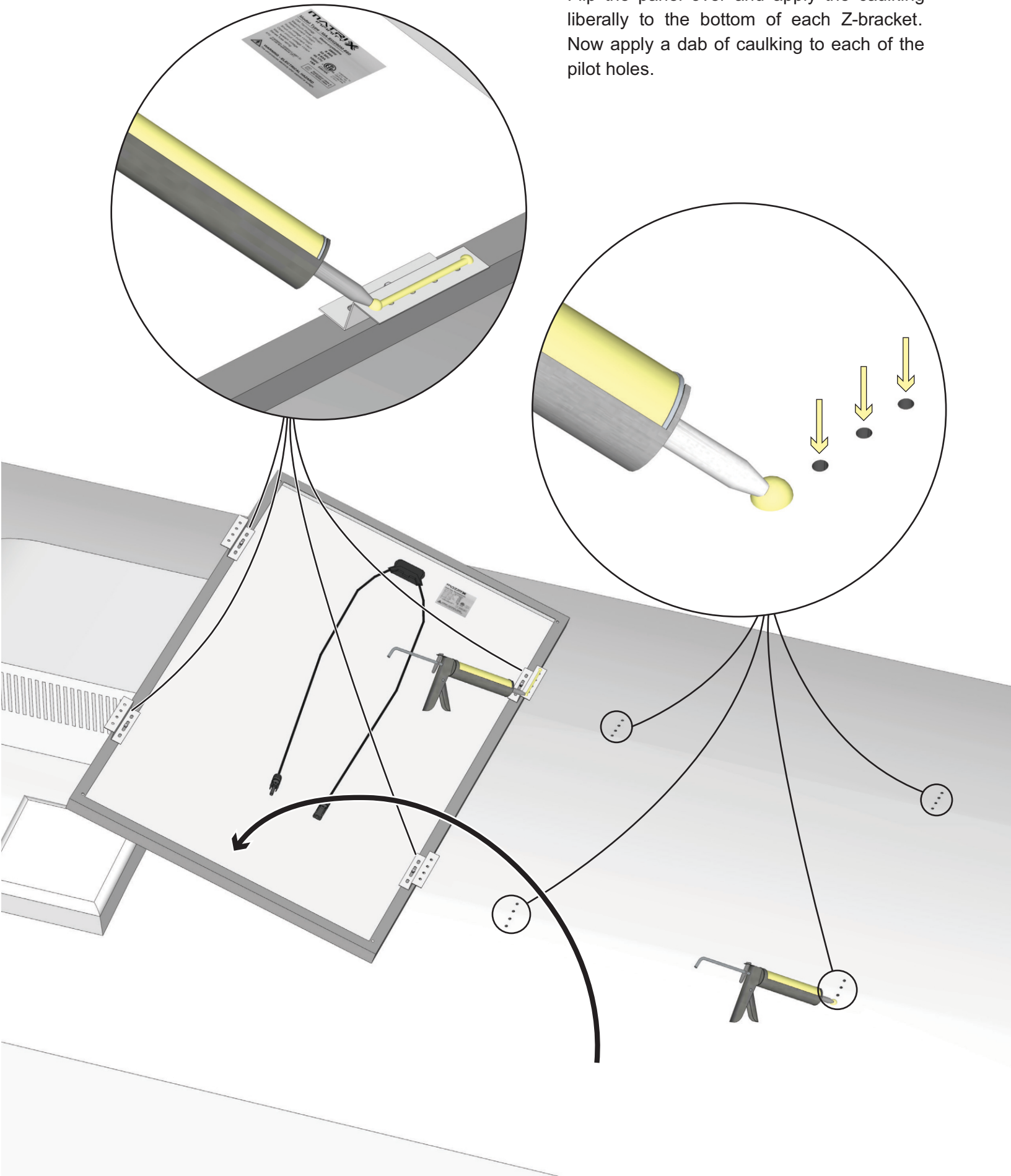

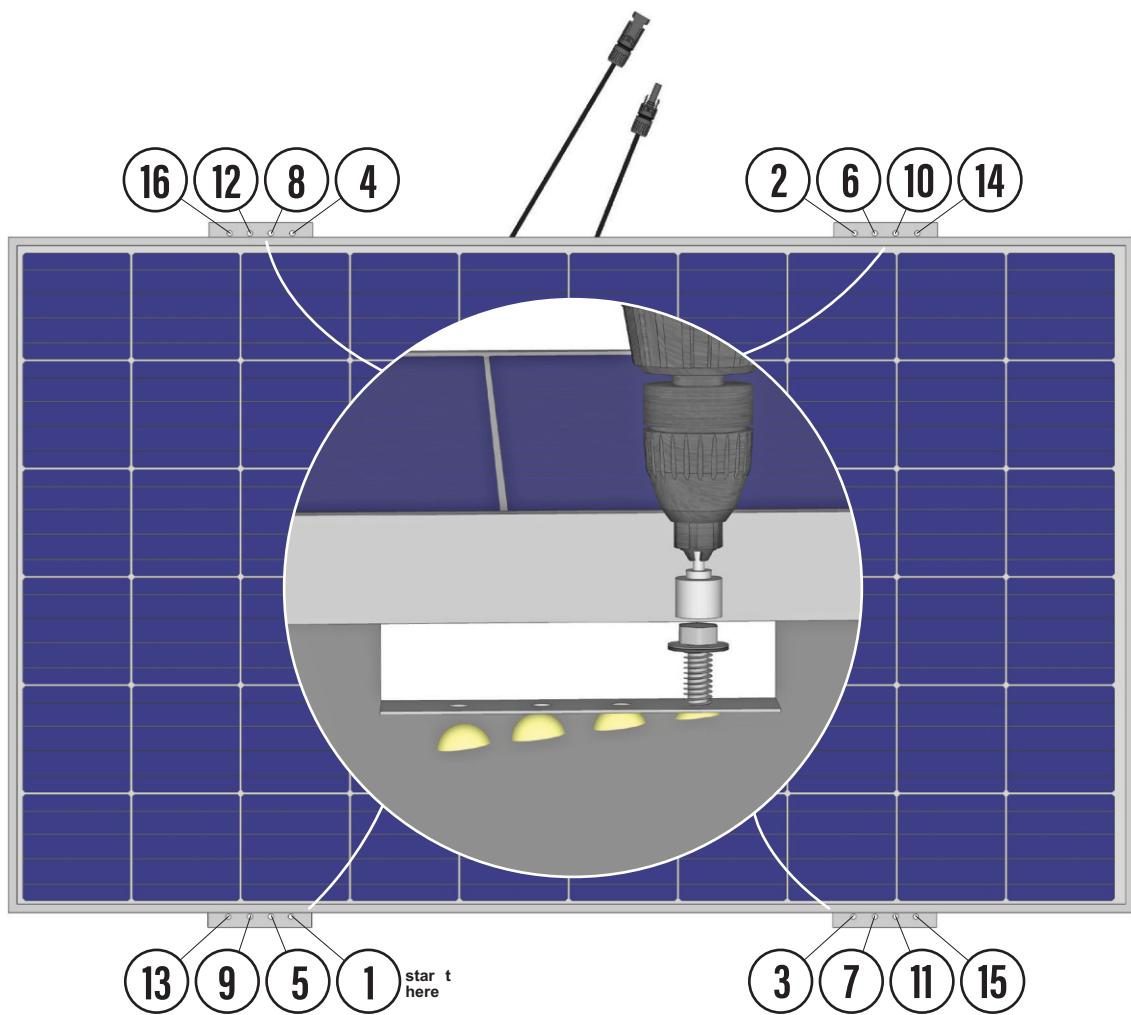

Now take the solar panel and align the pilot holes with the z-bracket holes and carefully lower it into place. Drill the lag screw into pilot hole number 1, making sure not to over-torque. Repeat process in the order of the above diagram.

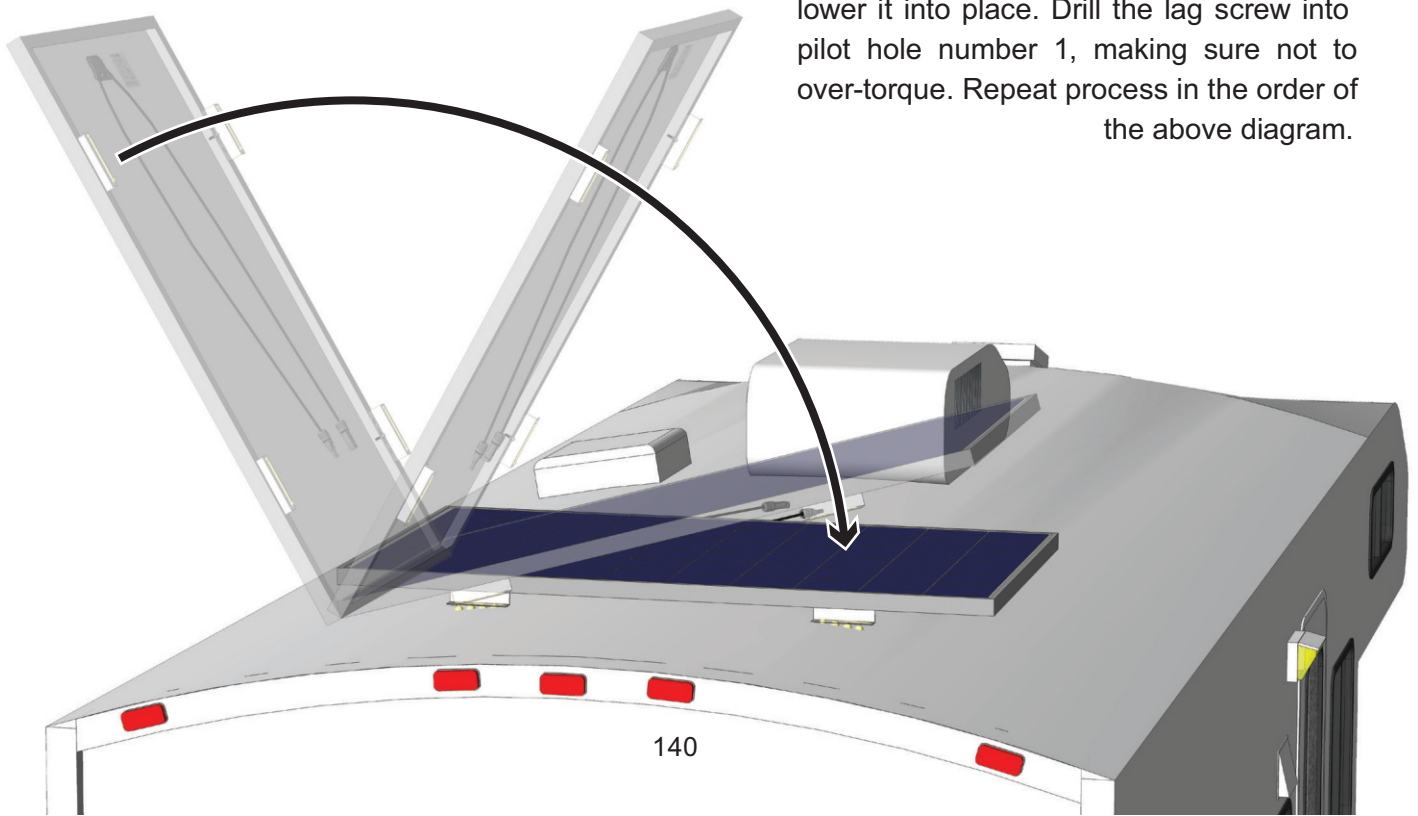

DISCLAIMERS

IMPORTANT: Please follow installation and wiring instructions exactly as outlined to ensure safety. We recommend installation by solar professionals & electricians to ensure adherence to relevant electrical codes. We have made every reasonable effort to ensure the accuracy of the instructions in this manual, but Solar Online Ltd does not guarantee that the information is error free, nor do we make any other representation, warranty or guarantee that the information is accurate, correct, reliable or current.

DISCLAIMER: This kit has been engineered for use in home applications. Any variance by the end-user is solely of their own discretion. Solar Online Ltd. assumes no responsibility for improper installation in accordance with any laws and regulations governing: cottage, residential or commercial applications. Solar Online Ltd disclaims liability for any direct, indirect or incidental damages caused by, or in case of, installation not performed following the instructions and cautions in this manual. Solar Online Ltd will refuse requests for exchanges or returns, resulting from the purchase and installation of items which do not comply with local codes. To avoid such concerns Solar Online Ltd recommends installation by a professional electrician or solar installation technician. Examples that are shown within this manual are for illustrative purposes only.